



## Shopping Center Space Available 982 Main St., Fishkill, NY

### PROPERTY HIGHLIGHTS

- Total gross leasable area in the shopping center is 120,960 sq. ft.
- 5:1 parking ratio
- Co-tenants include: Sears, Gold's Gym, CVS, Kiddie Academy, UPS Store, and Quest.
- Traffic count of over 20,000 cars per day.
- Located on Main Street in the heart of the Village of Fishkill.
- Excellent access to I-84 and Route 9

### SPACE AVAILABLE

- Size:** 5,700 sq. ft. currently built out as a restaurant including kitchen equipment.
- Rental:** \$16.50 per sq. ft. (NNN).
- CAM & Taxes:** Approximately \$3.25 / square foot.
- Condition of Space:** As-is
- Occupancy:** Immediate

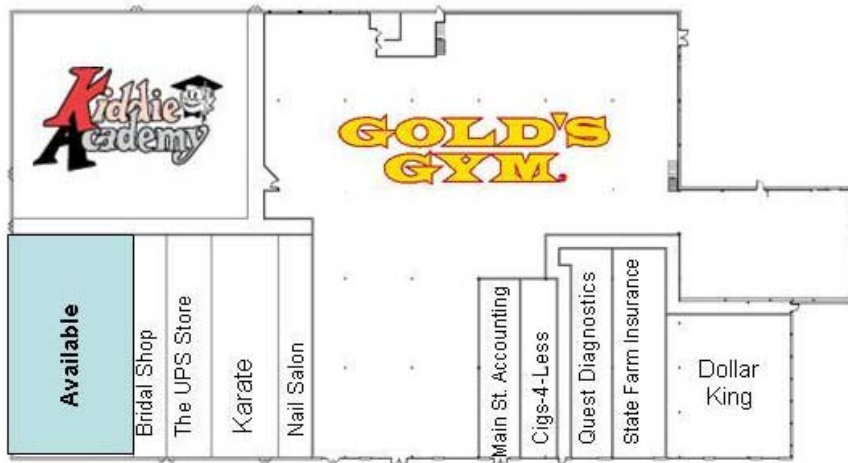

### DEMOGRAPHICS

	1 Mile	3 Mile	5 Mile	10 Mile
Population	3,093	23,431	60,822	208,636
Family Income – Average	\$60,953	\$64,449	\$66,094	\$69,527

#### For More Information Contact:

Jason Friedland  
 656 Central Park Avenue, Yonkers, NY 10704  
 Phone: (914) 751-4000 x 304 ♦ Fax: (914) 751-4001  
[jfriedland@westrockdevelopment.com](mailto:jfriedland@westrockdevelopment.com)

